



Vortex Weight Comparison



The Vortex Sweepout Assembly weight comparison is based on the weight difference between Dura Temp's double, triple and quadruple gob assemblies and the Emhart Flex single, double, triple and quad gob assemblies.

DOUBLE GOB	Emhart Flex	Dura Temp Vortex	Dura Temp Vortex SSB
Weight (lbs)	3.56	3.07	3.86
Weight Difference (%)	-	14%	8%
Bottle Diameter	3.750"	3.750"	3.750"

5.250" pocket spacing

TRIPLE GOB	Emhart Flex	Dura Temp Vortex	Dura Temp Vortex SSB
Weight (lbs)	4.40	3.31	4.13
Weight Difference (%)	-	25%	6%
Bottle Diameter	2.325"	2.325"	2.500"

3.750" pocket spacing

QUAD GOB	Emhart Flex	Dura Temp Vortex	Dura Temp Vortex SSB
Weight (lbs)	5.74	4.18	5.45
Weight Difference (%)	-	27%	5%
Bottle Diameter	2.362" [60]	2.362" [60]	2.362" [60]

3.750" pocket spacing

\*Weights are calculated using double high assemblies without the mounting bolt.

\*\*Dura Temp Vortex SSB = Dura Temp Vortex with Stainless Steel Braid

## DOUBLE GOB

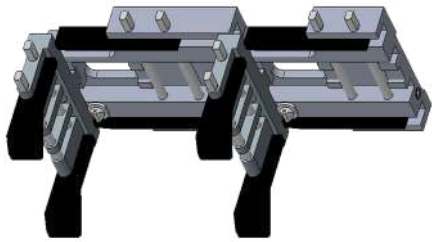

Emhart Flex

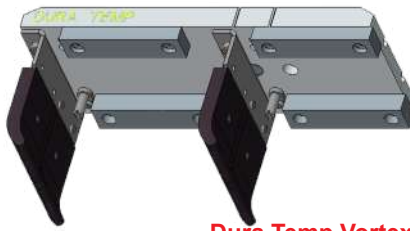

Dura Temp Vortex

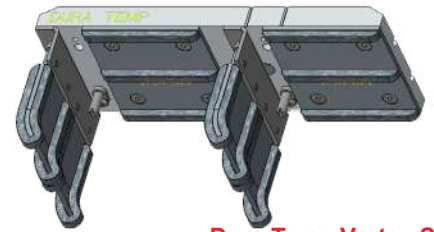

Dura Temp Vortex SSB

- Emhart Flex weighs 14% more than Dura Temp Vortex.
- Dura Temp Vortex SSB is just 0.30lbs more than Emhart Flex.

## TRIPLE GOB

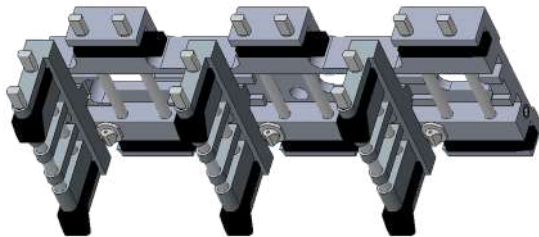

Emhart Flex

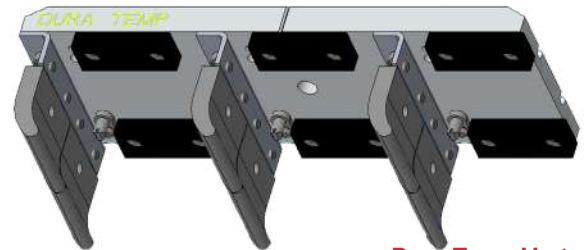

Dura Temp Vortex

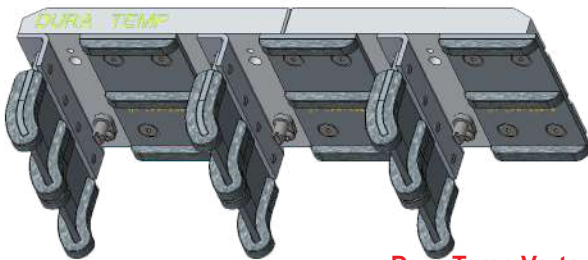

Dura Temp Vortex SSB

- Dura Temp Vortex is 25% lighter than Emhart Flex.
- Dura Temp Vortex SSB is 6% lighter than Emhart Flex.

## QUADRUPLE GOB

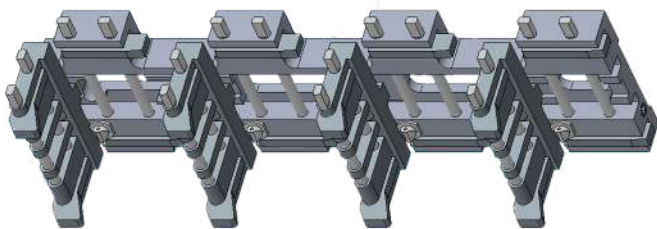

Emhart Flex

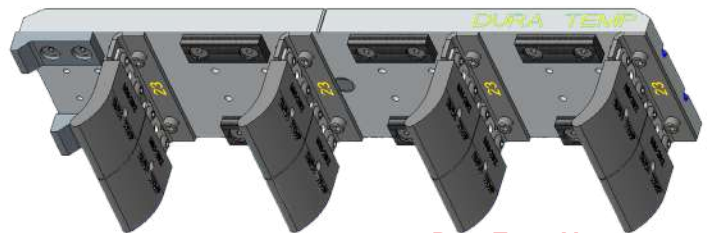

Dura Temp Vortex

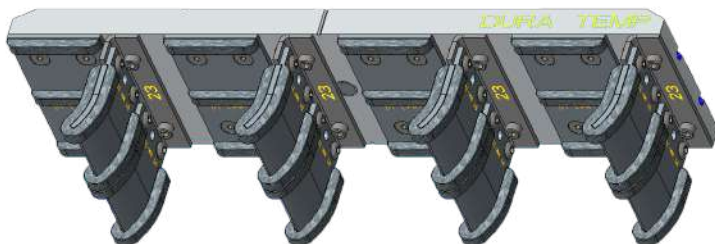

Dura Temp Vortex SSB

- Emhart Flex weighs 27% more than Dura Temp Vortex.
- Dura Temp Vortex SSB is 5% lighter than Emhart Flex.